

Thank you for purchasing this Johnson digital angle locator and ruler. We suggest you read this instruction manual thoroughly before using the tool and save this instruction manual for future use.

Key Features:

- Dual display indicates degrees/degrees minutes
- Stainless steel ruled blade in 1/32nds and mm
- Simple three button operation
- Blades lock at any angle

LOCATION OF PARTS/COMPONENTS

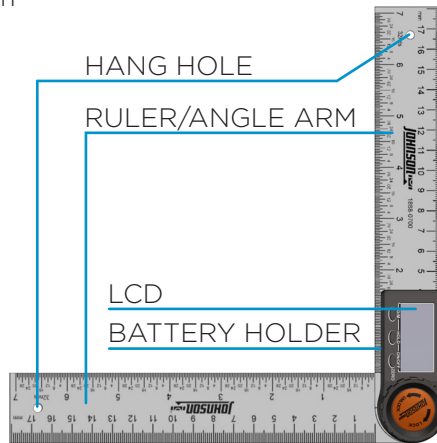
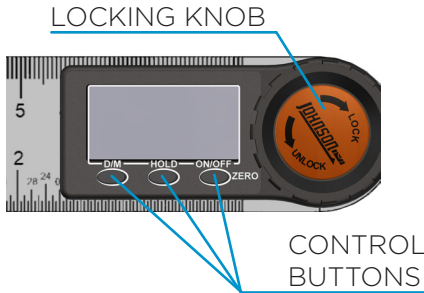

ON/OFF/ZERO button: Short press when unit is off, turns unit on. Short press when unit is on, displays "0.00". Press and hold for 3 seconds to turn unit off.

HOLD button: Single press displays "H" in lower right corner and holds last displayed value regardless of arm position. Pressing while held value is displayed turns off "H" in lower right corner and releases value. Display reads value relative to calibration.

D/M button: Toggles displayed engineering units from "0.00°" (degrees) to "0°00'" (degrees.minutes).

Locking Knob: When rotated clockwise, locks arm in current position. When rotated counterclockwise, unlocks arm making it free to rotate and measure other angles.

INSERTING BATTERIES

1. Open battery compartment by pressing button.
2. Remove battery holder by pulling out from opposite side.
3. Install 3V CR2032 lithium battery in holder, negative side up.
4. Re-install battery holder, making sure it is fully closed.

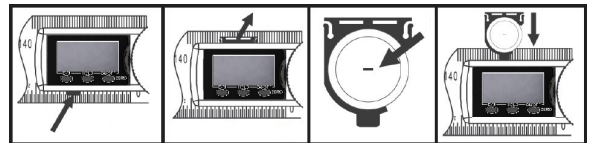

Note: 5 minutes of inactivity automatically turns unit off.

USING THE PRODUCT

Power the unit on by pressing the ON/OFF/ZERO button. Display should read "0.00" regardless of the position of the ruler/angle arms. Movement of the arms automatically indicates a measured angle with reference to the arm placement when unit was turned on.

To calibrate the display to a 0° reference angle, place the arms on a flat surface and press the ON/OFF/ZERO button as shown below. Display is now calibrated to a reference angle of 0°.

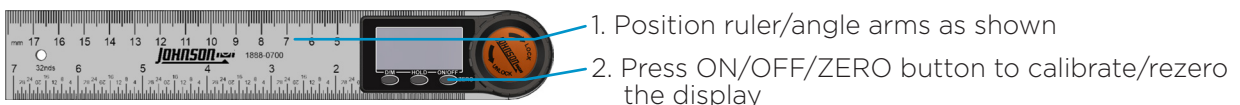

COMMON APPLICATIONS



Easy-to-read LCD displays in degrees / degrees minutes

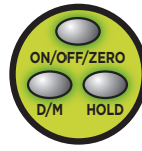

Zero function to set any angle as zero point

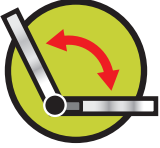

Ideal for checking and transferring angles for remodeling, cabinet installation, roof angles, format for concrete pours and much more

TROUBLESHOOTING

- **Tool does not power on or remain on**
Replace batteries. Check battery polarity.
- **LCD is not reading correctly**
Perform a calibration of the tool.
See "USING THE PRODUCT".

CARE AND HANDLING

- Remove any moisture or dirt with a soft, dry cloth.
- Remove the battery when storing the tool for an extended time (more than 3 months).

SPECIFICATIONS

Working Angle Range:	0° to 360°
Accuracy Angle/ Resolution:	0.05° (degrees) or 0.03' (minutes)
Battery:	1 x 3V CR2032
Operating Temperature:	32°F to 122°F
Weight/Dims	.36 lbs, 8.563" x 1.375" x 0.813"

PRODUCT REGISTRATION

Please register your product within 30 days of purchase. Registering ensures we have your information on file for warranty service even if you lose your receipt and lets us contact you if there is ever a product recall. We will never sell your information and will only send you marketing information if you opt-in.

To register, scan or click:
www.johnsonlevel.com/register



PRODUCT WARRANTY

Johnson Level & Tool offers a one-year limited warranty on this product. You can obtain a copy of this warranty on our website or by contacting our customer service department. The limited warranty contains various limitations and exclusions.

Note: The user is responsible for verifying proper calibration before each use. If you experience problems with this product, please contact us.

Email: service@johnsonlevel.com
Tel: 888-953-8357
Online: www.johnsonlevel.com

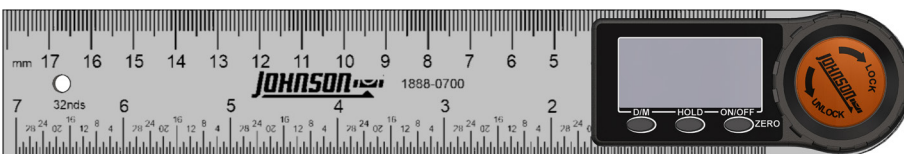

1888-0700
INSTRUCTION
MANUAL